

Installation Instructions & Use Recommendations

FMS Carpuride Carplay Mounts

These instructions must be read carefully and thoroughly **before** beginning work. FMS Solutions, LLC accepts no liability for damage caused by failure to observe the installation instructions or use recommendations. **Installation of this accessory does not change the factory specified load limits for saddlebags or radio box.**

Note: FMS Accessories does not sell, promote or endorse the Carpuride products. We simply make mounts for various accessories to fit BMW motors and this is one of them. We do not offer advise about operation or compatibility with various helmet headsets, etc.



Preparing the Display for Mounting:

The Carpuride W702 display has a 1" ball mount on the back. Using a Phillips screwdriver, remove the center screw and release the ball from the mounting pedestal.

Clean the M4 x 0.7 threads using a "Q-tip" to remove any contaminants, thread locking compound, etc.

The FMS mounts capture the pedestal and secure the display to the mount, providing a strong, theft-resistant mounting.



NAV Dash Mount

Non-NAV Dash Mount

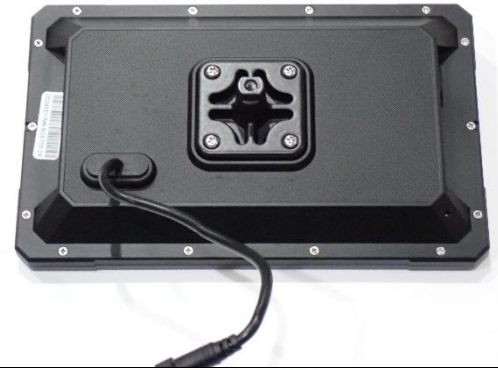

46_1604 - WINDSHIELD / MOUNT

Remove the BMW NAV dashboard from your motorcycle. You must first remove the windshield trims #3. Carefully hold the windshield and remove the two screws securing the windshield #4 – set it aside in a safe place. Lift off the windshield support #2.

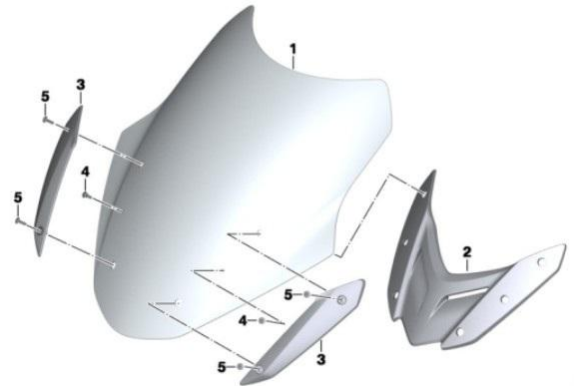

BMW NAV Dashboard Mounting:

For NAV dashboard mount, the W702 display must be attached to the mount prior to attaching to the NAV dashboard. Using the M4 x 25 screw with Vibratite on the threads, secure the W702 display to the NAV Dash Mount. Apply only moderate tension – this is a plastic part.



Remove the BMW NAV Dashboard as follows:

Remove the two rivets in the area shown as #5. These plastic rivets have a Phillips head and can be unscrewed by first raising the windshield, removing most but not all of the screw, then use the screw to pull the rivet out. Do this on each side.

Next use a T25 Torx driver and unscrew the two special bolts #3. At this point, the dashboard can be lifted up, starting at the forward point. Note there are two grommets and are engaged by points on the underside of the dashboard.

46_1635 - INSTRUMENT COVER FOR NAVIGATION SYSTEM

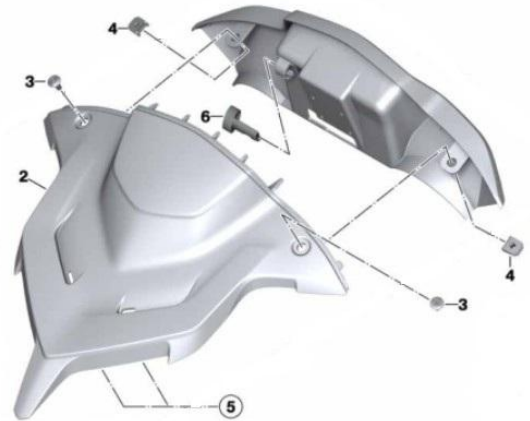

Follow the cable down from the NAV cradle and disconnect the white 3-wire plug. Do that by pressing on the side of the mating black socket housing to release the lock. Remove and set on a workbench with a towel to keep the dashboard from being scratched.

Photo to come soon

Remove the NAV cradle from the dashboard by removing the four M4 bolts securing the cradle to the two-part dashboard. Set the cradle assembly aside – it is not used.

Position the Carpuride mounting block over the same four bolt holes. Using the provided M4 x 10mm flanged screws, secure the mount to the dashboard.

Start all four screws before tightening and group to ensure that they all engage the threaded brass inserts in the FMS mount.

Snug all four screws. Don't over-tighten!

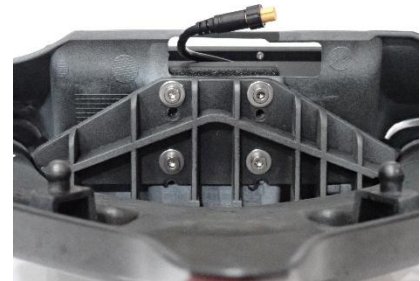

The Carpuride W702 comes with a generic connection harness with in-line fuse. To use the BMW NAV power connection, trim the harness to 30" and install the BMW NAV connector plug available separately.

Positions: #1 = Ground #2 = Unused #3 = Power



Secure wiring with cable tie to ensure it doesn't get caught in windshield mechanism. Lubricate the two grommets #3 with dielectric grease prior to reassembly of the dashboard so that they are not pressed out of position. Assemble in reverse order.

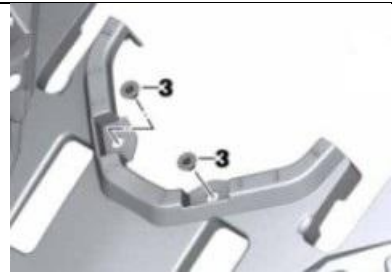

Non-NAV Dashboard Mounting:

The non-NAV dashboard is released the same way as the NAV dashboard. The difference lies in the need to measure and drill the two holes to attach the mount. Hence, some careful work is required. The mount & reinforcement plate are nested inside the central "chamber" visible at right near the #2.

46_1634 - INSTRUMENT COVER

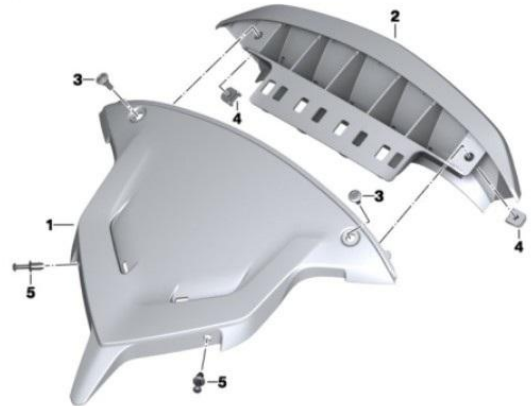

Carefully find the center line of the underside of the dashboard panel as shown at right. Use the molded tabs to help locate dead center. Measure down 33 mm from center (highest) point on arch of dashboard. Draw a horizontal line. Locate the bolt hole location 43 mm center to center.

Drill two M5 holes. Assemble mount on outside, reinforcement plate underside, washered nuts. Tighten snugly.

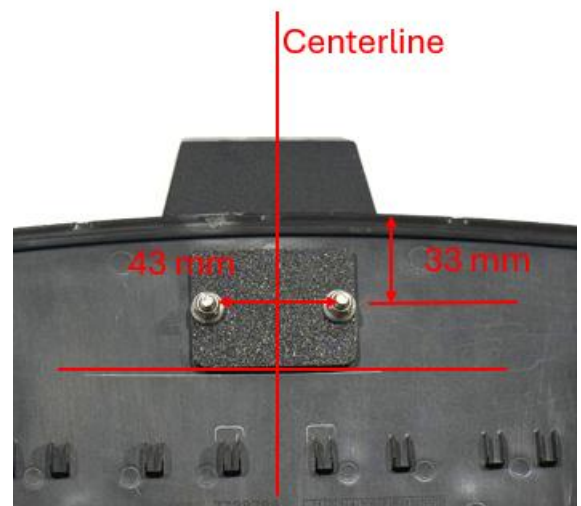
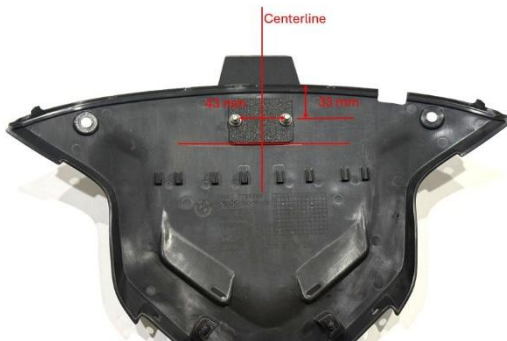

Trim a small relief to allow the Carpuride cable to run inside between the two halves of the dashboard. The hole shown in the photo was from previous equipment, so it is a bit oversized. It is best to cut the notch in-line with where the cable exits the display.



Screw the display to the mount using the provided M4 x 25 flanged bolt with Vibratite coating. Apply only moderate tension – this is a plastic part.

You will need to assemble the display on the dashboard, connect the cable (see previous instruction) and install the dashboard as described with the NAV dashboard.



Feedback: Thank you for your purchase and we welcome your feedback as we too want to make every accessory exceed your expectations. Report any comments, suggestions, problems or concerns to FMS Solutions, LLC at info@fmsaccessories.com .

Thank you!

About FMS Accessories

FMS Solutions, LLC Limited Warranty

FMS Solutions, LLC warrants to the first retail purchaser of new FMS Accessory products, to be free from defects in materials or workmanship, for a period of three (3) years from the original date of purchase as noted on the FMS Solutions, LLC invoice or original dealer invoice, except for paint and powder-coated finishes, which are warranted for the first 12 months only. LED lights from Fenix, Inc., Code 3, Inc. and Littlite are covered for 5 years by their manufacturer's respective warranties – processed through FMS Solutions, LLC.

This warranty extends only to the FMS accessory and does not include: damage caused by accidents or abuse; incorrect installation; labor to diagnose, remove, repair or replace; any consequential damage or loss of use. Any FMS Accessory suspected of being defective should be returned to FMS Solutions, LLC along with a copy of proof of purchase and warranty request form available on the FMS website. FMS Solutions, LLC will determine if the FMS accessory has a warrantable defect, and if so, will repair or replace the item and return it to the sender without charge. The decision to repair or replace said item is solely the prerogative of FMS Solutions, LLC.

Note: Police motors can operate in a very rough environment since police motors are a "tool". They can be dropped, knocked-over, etc. without concern as the officer has a job to do and determines what is necessary at any given moment. Warranty is for defects in materials or workmanship. Therefore, the ability of an item to become broken or damaged does not mean it is warranty ... it just means it is broken or damaged and in need of repair or replacement. No manufacturer warrants their products to be indestructible. Any questions should be directed to info@fmsaccessories.com .